

## NORTHUMBRIA UNIVERSITY

***Newcastle – History, Literature and Culture – Regionalism and Literature as a lens to explore British history and culture during the 19<sup>th</sup> and early 20<sup>th</sup> centuries***

A UNIQUE STUDENT EXPERIENCE

16 May – 5 June 2020



# WELCOME TO NEWCASTLE!

*The best student city in the UK*

Newcastle upon Tyne welcomes around 50,000 students every single year, from over 130 countries; making it a fabulous multicultural city for younger people.

The city centre is full of shops, restaurants, pubs and bars; while the student suburbs, such as Jesmond and Heaton, are home to vibrant pubs, music venues such as The Cluny, and cosy places to eat. Newcastle is big enough to constantly entertain and surprise, yet small enough to easily travel around on the underground Metro system, by bike, bus, or on foot.

Our famous Quayside has amazing bars and restaurants with views of the iconic Millennium Bridge, Tyne Bridge, Sage Gateshead and BALTIC Arts Centre.

**Arts-** Classical music at [Sage Gateshead](#) - Art exhibitions at [BALTIC Contemporary Arts Centre](#) - top West End shows at the [Theatre Royal](#).

**Shopping-** High street brands at [Eldon Square](#) and beautiful boutique shops – local and international markets along the Quayside and city centre. Europe’s largest shopping and leisure complex, The [Metrocentre](#) is just 10 minutes away.

**Sport-** [St James’ Park](#) a 52,000 all-seater stadium and the home of Newcastle United; [The Great North Run](#) - the worlds largest half-marathon; Rugby World Cup 2015 and Super League Magic Weekend host; [Newcastle Eagles](#) BBL Basketball - played onsite at Northumbria University!

**Nightlife-** [Pubs and bars](#) line our picturesque Quayside - city centre clubs including our renowned Collingwood Street show off bright lights into the early hours - numerous multiplex cinema venues at The Gate and Trinity Square campus accommodation.

**Food & Drink-** Newcastle boasts a superbly popular Chinatown, one of only five in the UK, as well as over [100 multicultural restaurants](#) from across the world. You will be well pushed to find a food which you cannot enjoy in Newcastle.



## DISCOVER THE NORTH EAST OF ENGLAND

The North East is perfectly located between coast and countryside and has something on offer for everyone.

From the beautiful Borders of Scotland, down to the rural North Yorkshire moors, this part of our country is so incredibly diverse that no two days are the same. In between all of the natural beauty and untouched forestland, there are towns and cities renowned for being a fabulous night out for students. Talk to our current and local students – they will tell you all the best places to visit!



The North East is perfectly located between coast and countryside and has something on offer for everyone.



### **Countryside**

Kielder Water and Forest Park - more castles than any other English county - rural and rugged Northumberland has been used as filming locations for Harry Potter, Robin Hood, Atonement and more recently, Transformers.

### **Beaches**

Designated as an Area of Outstanding Natural Beauty; Surfing beaches of Bamburgh - sandy beaches of Tynemouth - popular beaches of Whitley Bay - secluded beaches of Alnmouth.

### **Landmarks**

Hadrian's Wall - Harry Potter's Alnwick Castle - Northumberlandia - Angel of the North.

### **Further Afield**

Scotland is a one-hour train ride away - Amsterdam is a one-hour flight - London is a three-hour train ride.



# WELCOME TO NORTHUMBRIA UNIVERSITY



Newcastle Business School  
has joined the **top 1% of  
business schools** worldwide by  
gaining double accreditation  
from AACSB

Invested more than **£200 million**  
in our estate since 2005 to  
improve the student experience

Ranked **3rd in the UK** for  
international student  
satisfaction



One of the **largest universities**  
in the UK with almost **34,000**  
students from **131 countries**



## PROGRAMME INFORMATION

This “Maymester” is a three week programme on the culture and heritage of the Northeast of England delivered through a series of lectures and seminars at our Newcastle campus and field trips to points of interest around the region.

### Content

The course will provide a cultural and historical overview of Britain during the 19<sup>th</sup> and early 20<sup>th</sup> century through the lens of regional literature, history, and cultural developments that relate to the North East of England and primarily the city of Newcastle during the era of industrial expansion in Britain. This is the period when people of the region – known as ‘Geordies’ – had a distinct and strong regional identity. It will explore how/whether this regional cultural identity remains.

Alongside the study of historical evidence and sources this course allows students to examine the interdisciplinary connections between history and literature (fiction, creative nonfiction, poetry, diaries and letters) to examine the social and historical contexts of literary works. Though its main focus is historicism it will also, through an examination of genre, style, character presentation, language (particularly the use of colloquialism by authors) and reader reception, use gender studies, cultural materialism and Marxist theory to explore, and challenge, concepts of class, gender and culture.

As this module is specifically for international students this provides a manageable way to explore and examine key historical, cultural developments and a range of literature that relate to class, gender, industrial development and decline, alongside regionalism. Teaching includes both broad interpretive lectures and detailed and focused seminar discussion and textual analysis/deconstruction, often of textual extracts from novels, poems and songs produced within, or about, Newcastle.

The module will also include study visits, for example, to Beamish Museum, Cragside House and The Literary and Philosophical Society of Newcastle, as well as a visit to the city archives, in order to directly relate class based learning and analysis of literature sources (novels, poetry, diaries and letters) to historical sites and evidence.

### Application requirements

Good academic standing

### Accommodation information

Accommodation available to students for the programme in 2020 is to be confirmed but an example of the type of accommodation is here:

#### Portland Green

Portland Green is a short walk from Northumbria as well as Newcastle city centre and the famous Quayside.

## Facilities

- High speed Wi-Fi
- En-suite rooms
- Smart TVs
- Dishwashers
- On-site laundry
- Bike storage
- 24/7 on-site staff
- Private outdoor courtyards

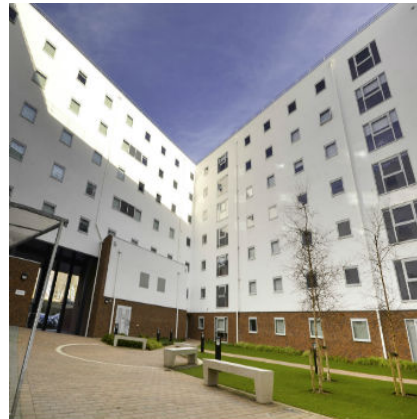

For further information visit the [Portland Green](#) website

## Fees

The fee for the programme is **£2,990**. It includes:

Course fees and materials

Module field trips

Induction, city tour, welcome dinner and farewell lunch

En-suite self-catered accommodation

24/7 assistance and emergency contact (Safe Zone App)

Gym membership

Social programme including and a weekend stay at Alnwick Castle (Hogwart's from Harry Potter)

## CONTACT INFORMATION

International Development

Northumbria University

Newcastle upon Tyne

NE1 8ST

UK

Email: [fc.niss@northumbria.ac.uk](mailto:fc.niss@northumbria.ac.uk)

Telephone Enquiries: +44 (0)191 243 7446

Applications: +44 (0)191 243 7906

Website [northumbria.ac.uk/NISS](http://northumbria.ac.uk/NISS)



 [facebook.com/NorthumbriaNISS](https://www.facebook.com/NorthumbriaNISS)

 [@studyabroadatNU](https://twitter.com/studyabroadatNU)

 [#nustudentsabroad](https://www.instagram.com/nustudentsabroad)